

APM Team Center Best Practices DevXChange

Andreas Reiss – CA Technologies – APM Global SWAT Team

May 2016



Agenda

1

NODES AND MULTIPLE DIMENSIONS

2

THE POWER OF PERSPECTIVES

3

GROUPING BEST PRACTICES

4

BACK TO JULIET

Nodes and multiple Dimensions

Solving Problems – Different Angles

Different views at the same problem

The right view is the key to identify the problem.



Solving Problems – Different Angles

The multiple “personalities” of a Team Center node

- APM Team Center with the power of assigning multiple attributes to nodes
- Attributes can be created by
 - Rules
 - Manual Assignment
 - Transactional Properties (Traces)
- Attributes are time sensitive

Name	Apps Mediator URLs transactions/book
Type	GENERICFRONTEND
Alerts Summary	
Alert Status	Unknown
Variance Intensity	<div><div></div><div></div><div></div></div> 0/3
+ Alerts	(1)
+ Performance overview	(5)
- Basic Attributes	(6)
Name ^ Live Value	
agent	reian06mac171 NowhereBank Mediator
applicationName	Mediator
hostname	reian06mac171
name	Apps Mediator URLs transactions/book
ProcessedBy	FrontendVertexIdentifier
type	GENERICFRONTEND
- Custom Attributes	(7)
Name ^ Live Value	
Business Critical	Yes X
location	Frankfurt X
owner	Pete X
region	Distributed - Mediation X
role	Internal Interface X
tier	Mediator
Troublemaker	On High Traffic X
<new attribute name>	

Solving Problems – Different Angles

The multiple “personalities” of a Team Center node

Looking into different roles of a Web Service Client Call



The Power of Perspectives

The Power Of Perspectives

Everything starts with a sketch

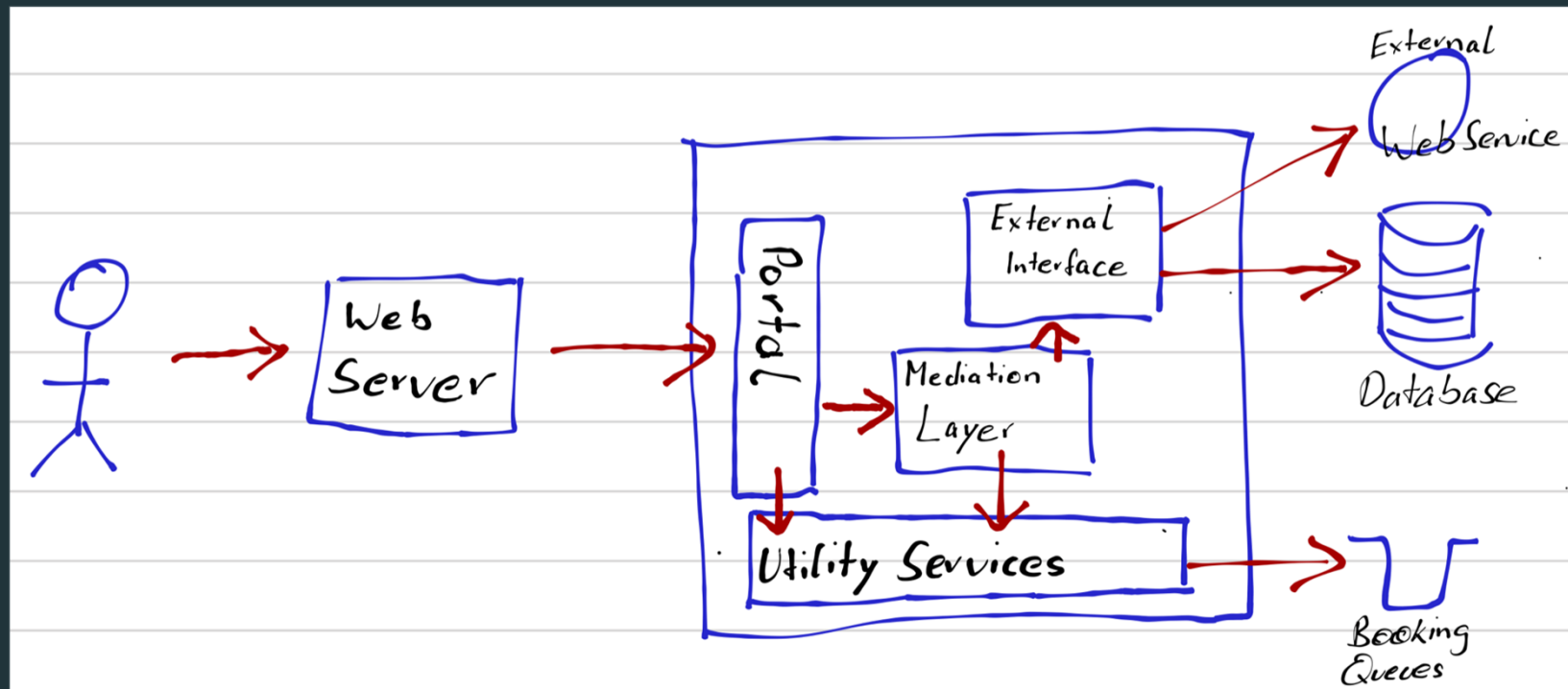

The Power Of Perspectives

Serving multiple Stakeholders

- APM Team Center with the strength to look at your environment from multiple angles

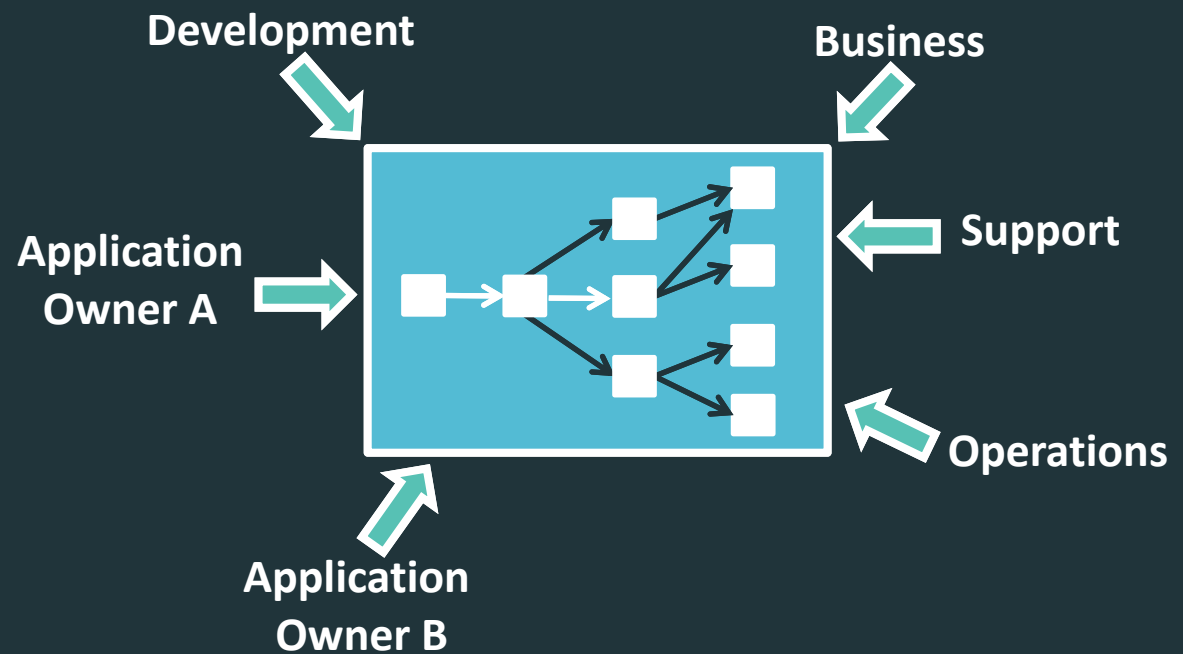

The Power Of Perspectives

Not getting lost in multiple Drilldown levels

Combine filters and perspectives to investigate and problems

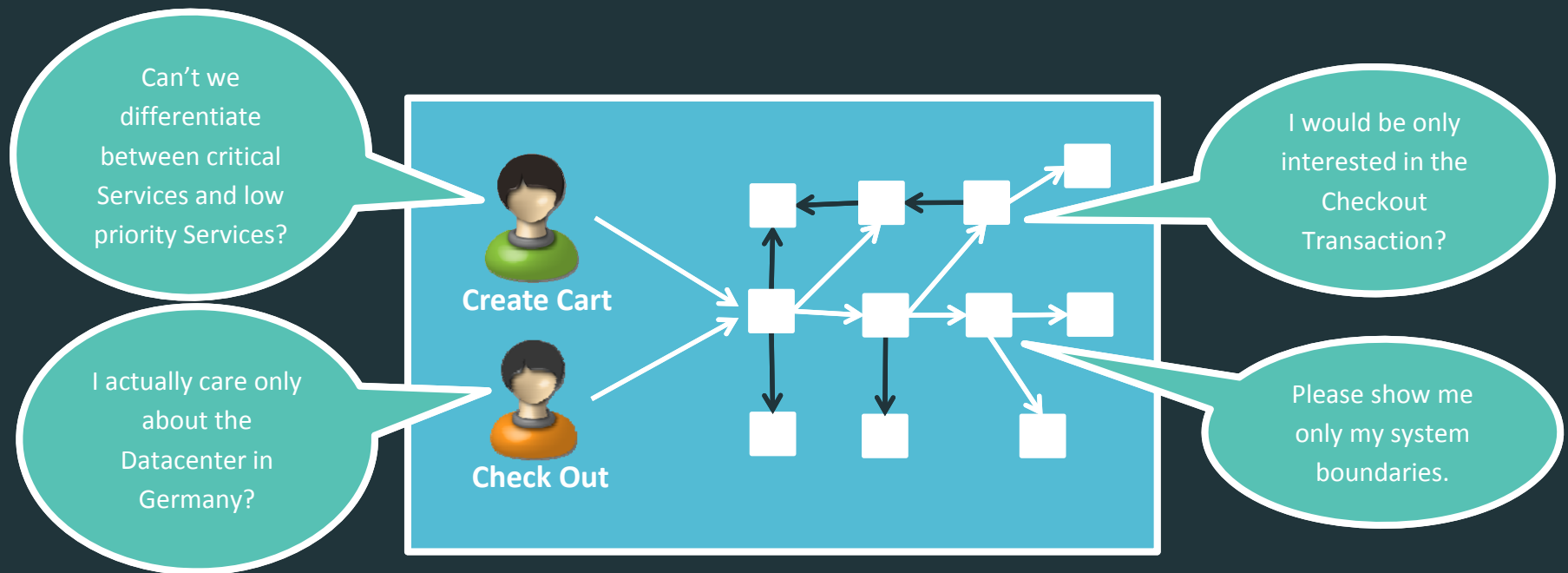

Grouping Best Practices

Grouping Best Practices

Location Based / Data Center

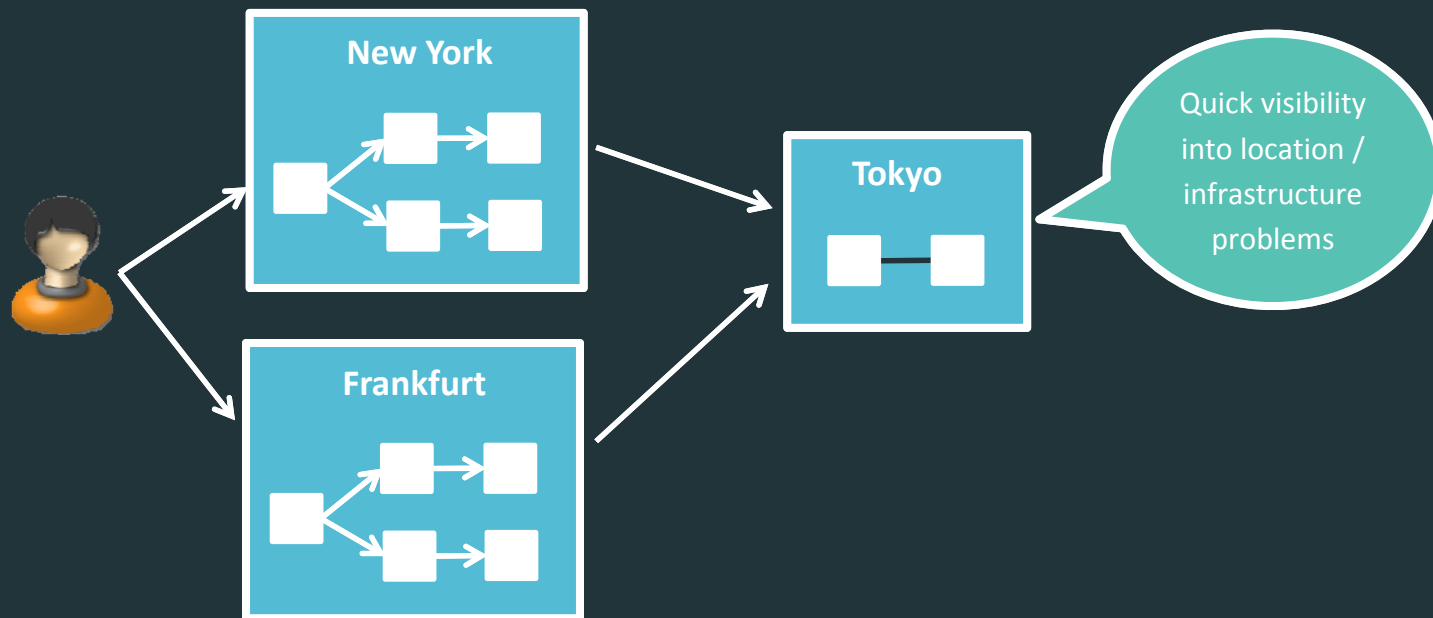

Grouping Best Practices

Cluster / Loadbalancer

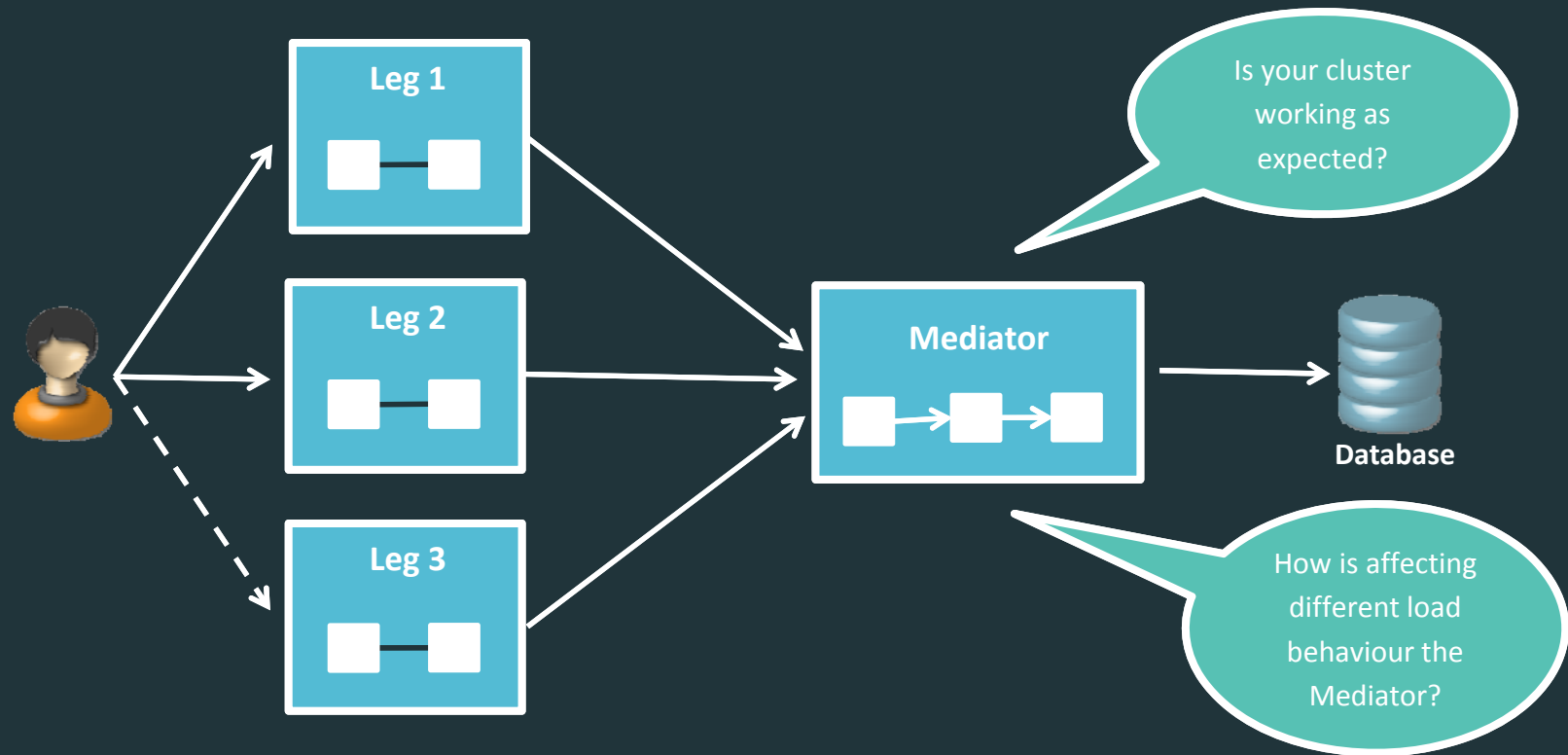

Grouping Best Practices

Communication

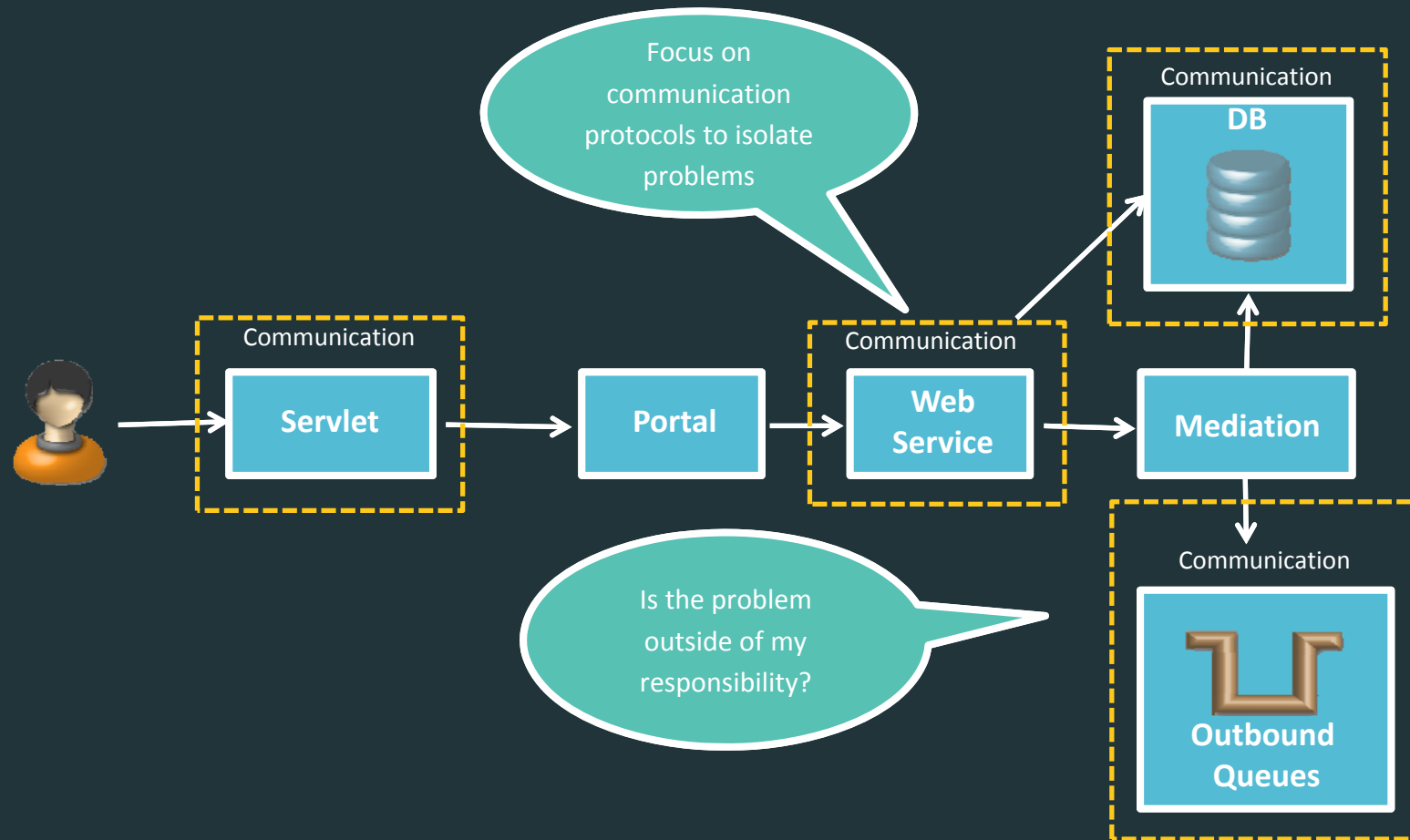

Grouping Best Practices

Annotation

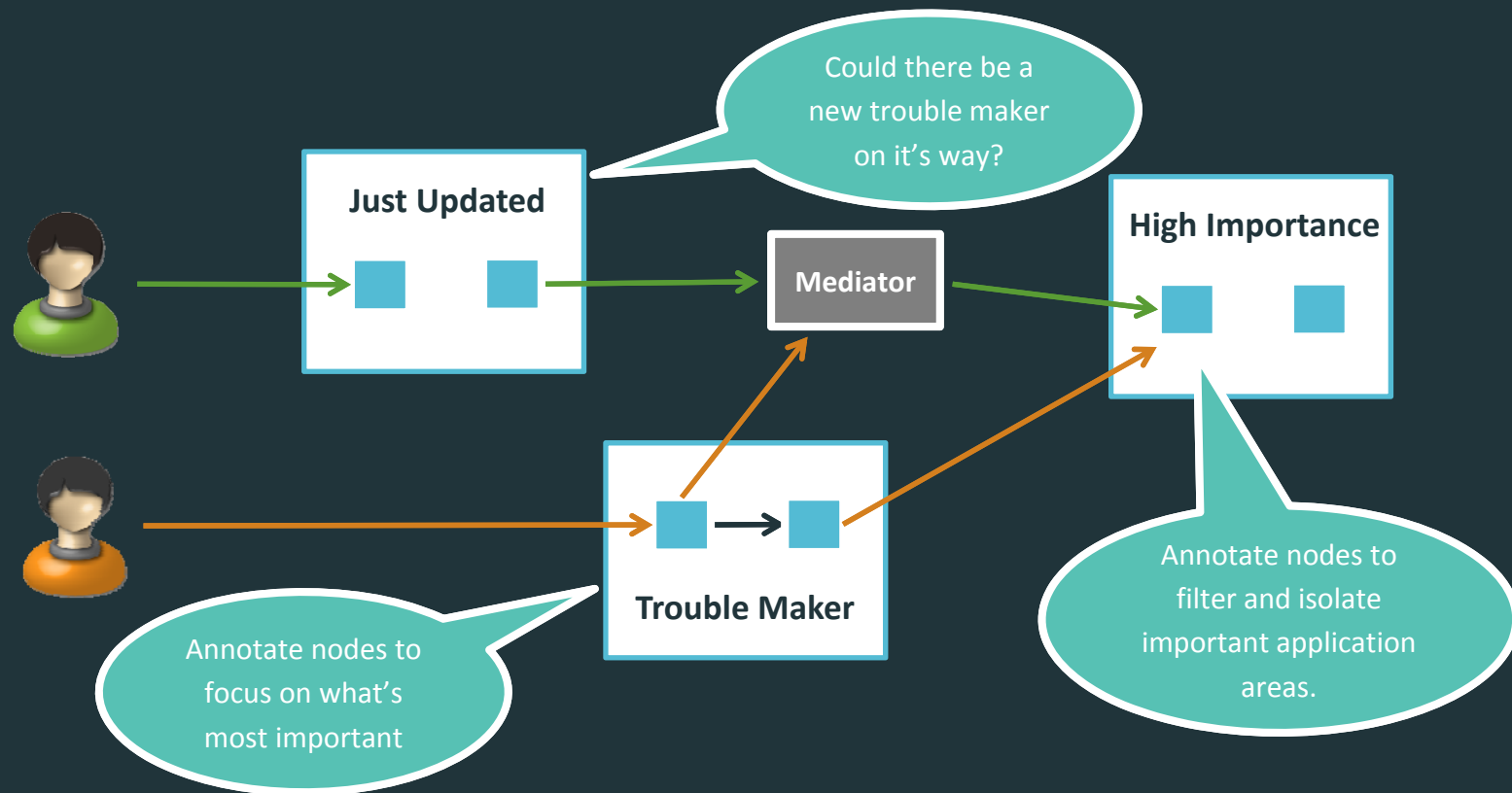

Returning to Juliet

Team Center Task - Test Enrichment

- How to link problems with tested releases?
 - Release information in Team Center nodes
 - Test Dates in Team Center
- Show Test Coverage in Team Center

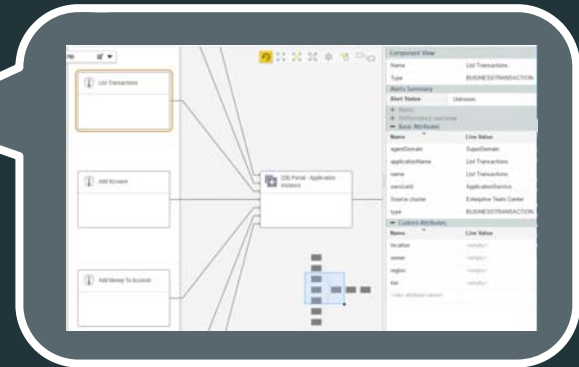

Team Center Task - Test Enrichment

- The Power of Perspectives now allow Juliet to group the environment by releases

Create a Perspective

Define levels:

- 1 Nowhere Bank Build
- 2 Business Service
- 3 Application Instance
- 4 -- select attribute --

Perspective name:

Nowhere Bank

☒ Perspective is public

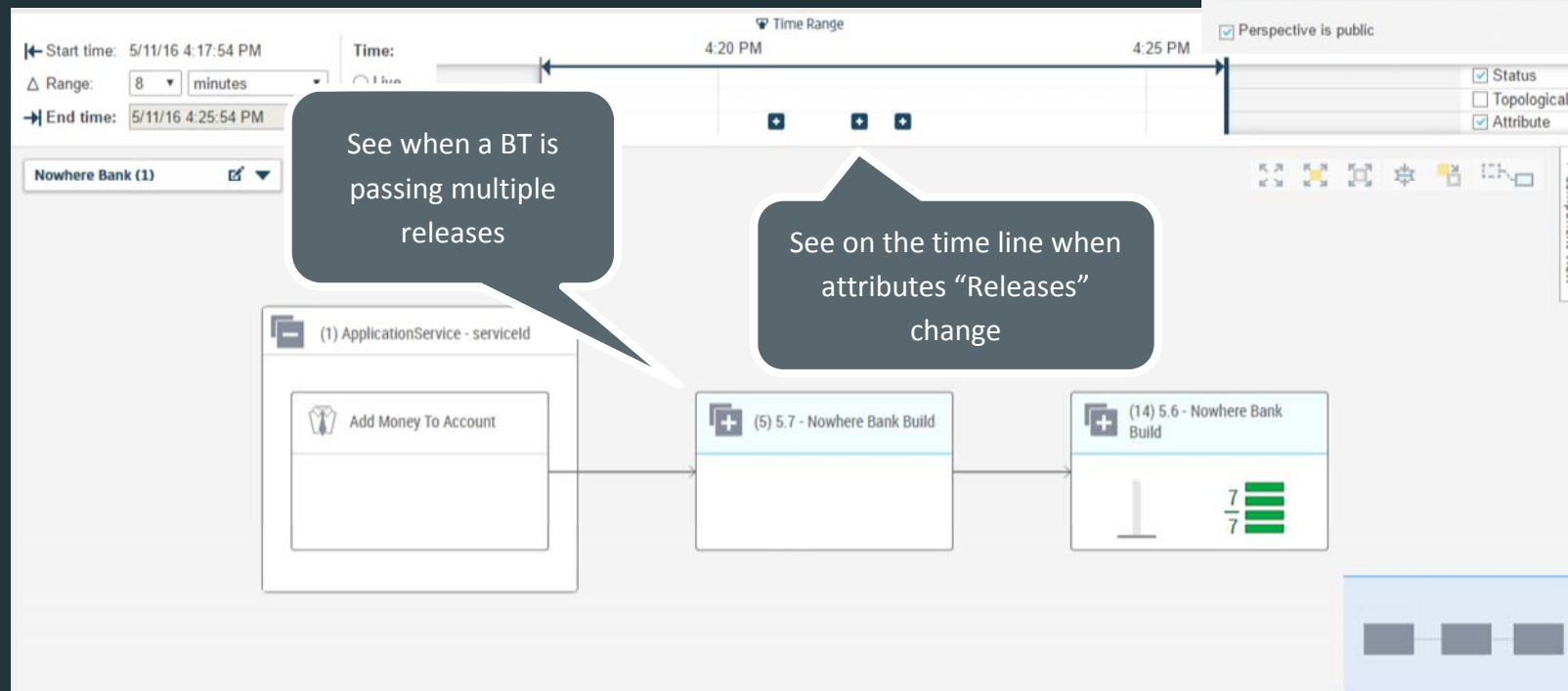

Team Center Task - Test Enrichment

Use highlighting to check which BT use Application Releases

The screenshot displays the CA APM Team Center interface. At the top, the header shows 'APM Team Center' with the current time '5/11/16 4:25:54 PM', a range of '8 minutes', and a mode of 'Historic'. The main area features a 'Filter By' section with 'Business Transaction (1)' selected. Below this, a 'Time Range' section shows a timeline from '4:20 PM' to '4:25 PM'. A 'Highlight' section is active, showing a yellow highlight bar. A dialog box is open on the left, titled 'Nowhere Bank Build (1)', with options to 'Sort Danger to OK', 'Sort OK to Danger', 'Sort A to Z', and 'Sort Z to A'. The dialog also has a 'Filter' input field and a 'Select All' checkbox. The main area displays a complex transaction flow diagram with various components like 'validateRequest', 'BackendsOut...', 'transactions', 'BackendsComm...', 'Add Money To A...', and 'BookingService...'. The diagram is rendered in a light blue and yellow color scheme. The right side of the interface has a 'Component View' panel.

Team Center Task - Test Enrichment

Use highlighting / filtering to identify which components are hit by failed tests

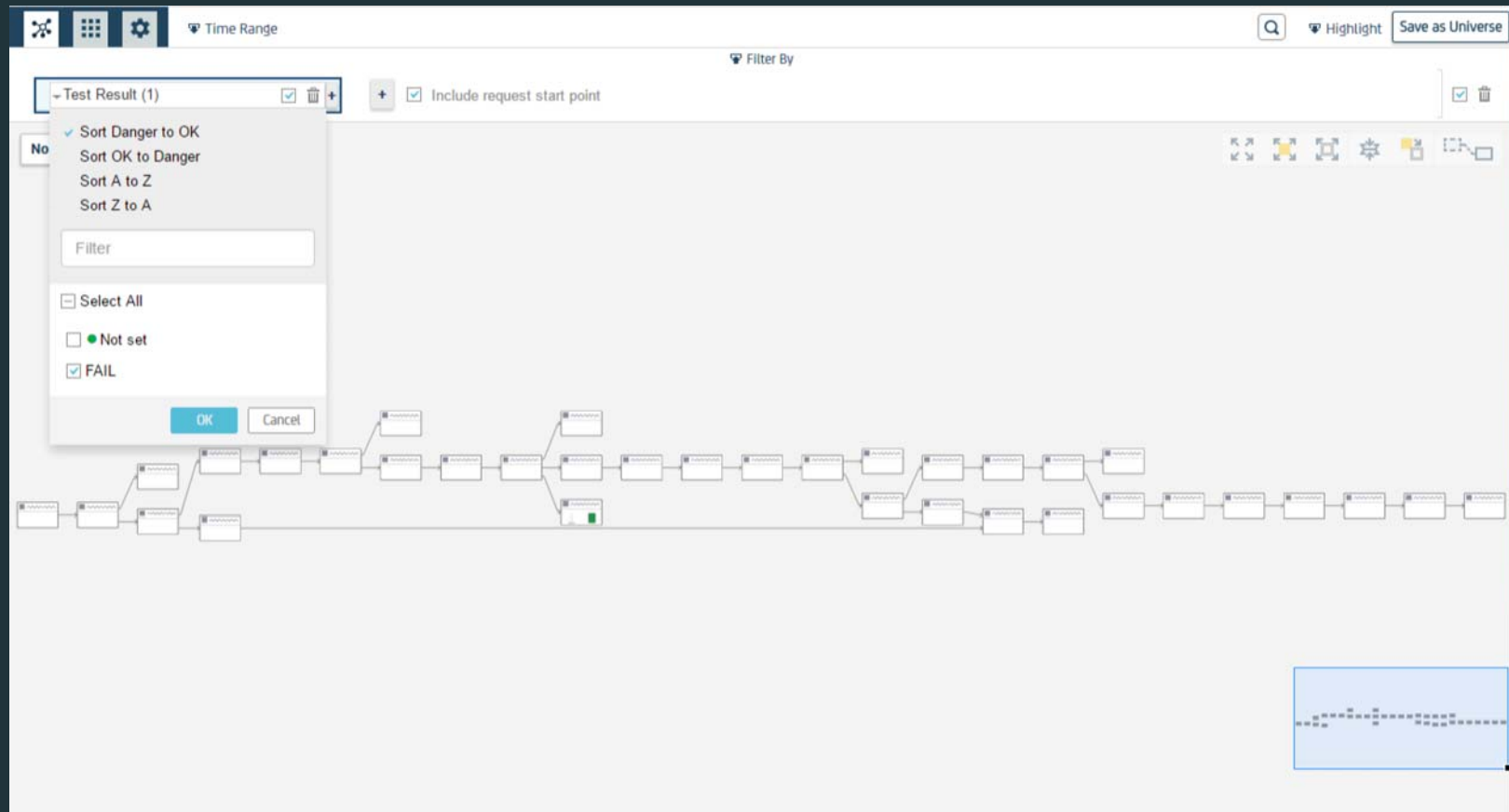

Q&A



Andreas Reiss

Engineering Services Architect = APM Global SWAT Team
Andreas.reiss@ca.com

